



flowstore[®]

Enclosures

Foundation Requirements

First Publication Date: 01/09/2020

Revision:

Revision Date:

- The enclosure panel is lowered onto the foundation.
- The enclosure is secured to the foundation using the correct fixing type depending on the foundation type.
- A bead of silicon sealant is applied to seal the flange to the foundation joint.

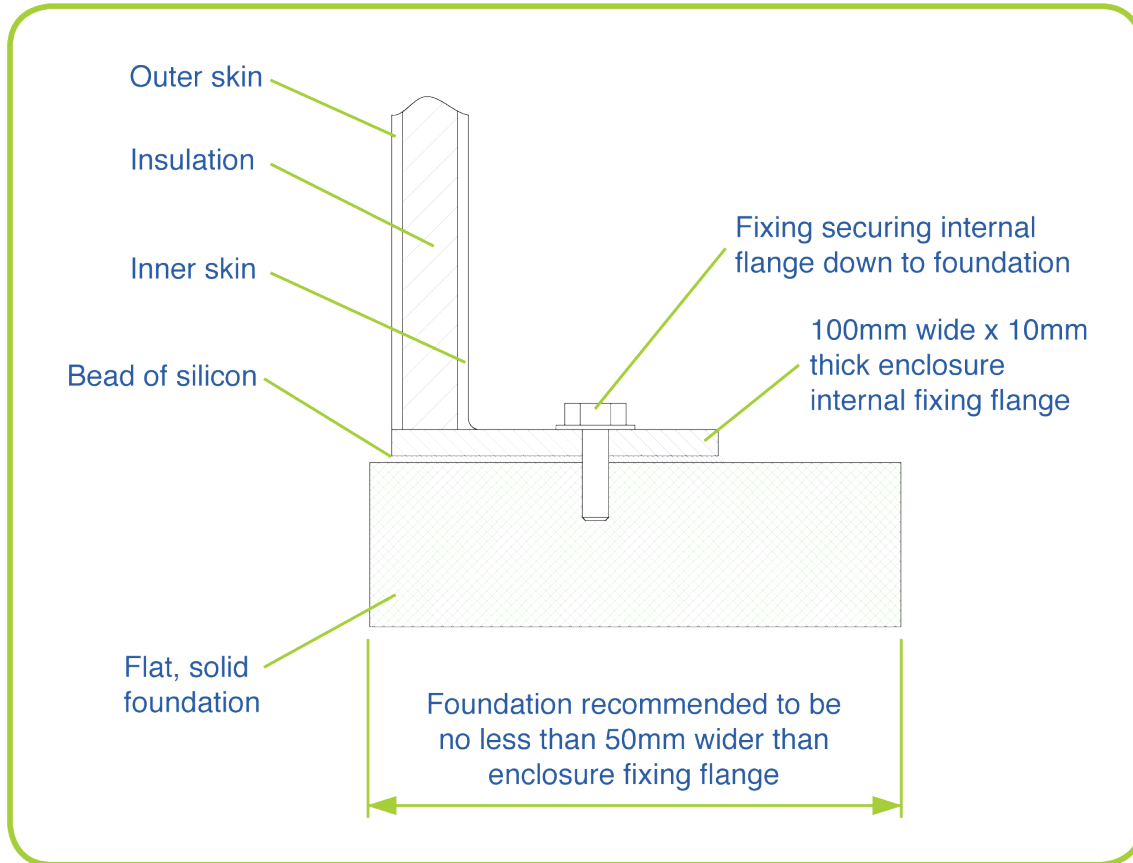

For the successful installation of Flowstore GRP Housing Enclosures, please ensure the following requirements are met:

- The foundation area must be no less in length and width than the external dimensions of the enclosure.
- The foundation must be constructed so as to be capable of supporting the weight of the enclosure and equipment contained within it.
- The foundation must be continuous and be no more than $\pm 2\text{mm}$ over any given metre.
- The foundation must be free of any local protrusions and debris of any kind.

For enclosures to be mounted on a raised kerb or up-stand, the up-stand must be:

- Constructed from timber, concrete or brick.
- Recommended to be a minimum of 50mm wider than the enclosure fixing flange.
- Be sufficiently high enough to prevent ingress of water (minimum 50mm recommended).
- Have an external dimension no less than the external dimension of the housing.

NOTE: If the enclosure is being fixed down to a flat foundation rather than a raised kerbing or where the foundation does not meet the required tolerances, we cannot guarantee a 100% seal against ingress of water.

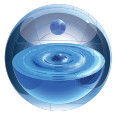

flowtech[®]
WATER SOLUTIONS

flowzone[®]

MEMBERS AREA

This section of the **flowtech**[®] website holds information exclusively for members. Members will need to log in to gain access to these pages.

Our member's will be granted exclusive access to our technical resource library. Within this resource is a wide range of product information including data sheets, technical drawings, O&M Manuals and training videos



flowcare[®]

AFTER SALES SERVICE

At **flowtech**[®] we operate a network of Service Engineers located throughout the UK who are supported by our offices located in Cumbria and Greater Manchester. The distribution of engineers means that in the majority of cases we are less than 4 hours away from attending a customer call out.

We place great emphasis on providing technical back up to support our Service Engineers in resolving some difficult operational and technical issues. We pride ourselves on completing a project on time, within budget and never leaving a problem unresolved, or a customer waiting. This quality of service has made us the first choice for our customers.

FOR FURTHER INFORMATION OR ASSISTANCE

contact us

Flowtech Water Solutions are experts in water services and water booster sets. We have continuously supplied a wide range of standard and custom products since being founded in 1996.

MANUFACTURE & SUPPLY

TELEPHONE : 0333 200 1756

EMAIL: info@flowtech.org.uk

SERVICE & MAINTENANCE

TELEPHONE : 0333 200 1813

EMAIL: service@flowtech.org.uk

WEBSITE: www.flowtech.org.uk

ADDRESS : Unit 1 Lock Flight Buildings, Wheatlea Industrial Estate,
Wigan, Greater Manchester WN3 6XP United Kingdom



Membership No. 700106

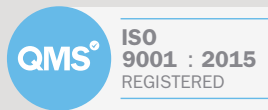

Certificate No. 185352020